

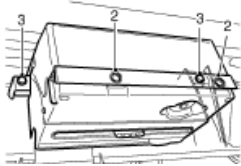

SLS Spacer Install

1. Raise vehicle and support with axle stands on the chassis. Leave wheels touching the ground.
2. under LH side of vehicle locate SLS compressor housing. Remove cover by turning the 2 large plastic screw on the front.



3. You will see 3 pipes on the LH of the compressor, loosen (but do not remove) the 2 outside pipes (items 12 & 14). This will release the air in the air springs.

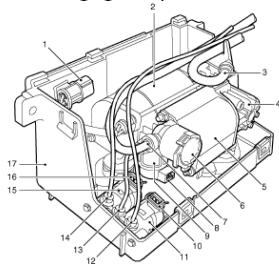

4. Remove 2 clips from the top of one of the air springs housings. Rotate air spring to unclick from axle and lift to one side.

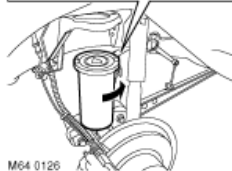
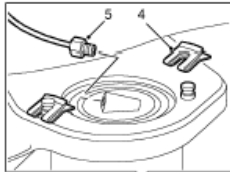

M64 0126

5. Bolt spacer to axle.
6. Refit air spring in reverse order.
7. Fit extension to sensor arm at point 3. The should be installed in a near vertical position. Final adjustment of this can be done when vehicle is taken off axle stands and air springs pressurised.

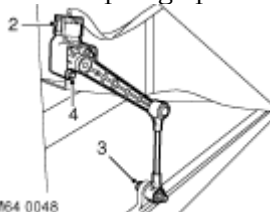

M64 0048

8. Now do the other side.
9. Tighten pipes at the compressor
10. Run engine to pressurise air springs and to check for leaks at the compressor.
11. Refit compressor housing cover.
12. Remove axle stands.
13. Run engine again for the system to settle.
14. Final adjustment of the extensions to the sensor arms to gain required height.